



HOW TO USE THIS INSTALL GUIDE

- 1** Open the Bookmarks menu and find your vehicle OR scroll down until you find the install guide for your vehicle.
- 2** Print only the pages for your vehicle using the advanced options in the Print menu.
- 3** Install your Maestro RR according to the guide for your vehicle.

WARNING

Pressing the printer icon or “quick printing” this document will print all of the guides in this compilation.

RETAINS HEADS UP DISPLAY, STEERING WHEEL CONTROLS AND MORE!



PRODUCTS REQUIRED

iDataLink Maestro RR or RR2 Radio Replacement Interface
iDataLink Maestro CAM1 Dash Kit (**Head Unit Adapter ready kit**)

PROGRAMMED FIRMWARE

ADS-RR(SR)-GM02C-DS

ADDITIONAL RESOURCES

[Maestro RR2 Programmable Outputs Guide](#)
[CAM1 Dash Kit Installation Video](#)

OPTIONAL ACCESSORIES

K40
ELECTRONICS
ESCORT

Click here for:
[Radar Installation Guides](#)

HEAD UNIT ADAPTER:
ACC-HU-PI01, SON1, KEN1, KEN2, ALP1

WELCOME

Congratulations on the purchase of your iDatalink Maestro RR Radio replacement solution. You are now a few simple steps away from enjoying your new car radio with enhanced features.

Before starting your installation, please ensure that your iDatalink Maestro module is programmed with the correct firmware for your vehicle and that you carefully review the install guide.

Please note that Maestro RR will only retain functionalities that were originally available in the vehicle.

TABLE OF CONTENTS

Installation Instructions	3
Wiring Diagram	5
Radio Wire Reference Chart	6
Module Diagnostics	7
Troubleshooting Table	8

NEED HELP?

 1 866 427-2999

 maestro.support@idatalink.com

INSTALLATION INSTRUCTIONS P1/2

DASH DISASSEMBLY (Center console removal)

Note: It is not possible to install the CAM1 dash kit and aftermarket radio without removing the center console.

1. Engage the parking brake. Put the shifter all the way back. (Fig. 1.1)
2. Pry upward and remove the center console trim. Unclip the center console wiring harnesses and remove it. (Fig. 1.2)
3. Using a panel tool, remove the side panels of the center console by prying the panels out and releasing the retainer clips. (Fig. 1.3)
4. (Automatic transmission) Remove a small cover on the front of the shifter to expose (1) torx screw. Remove the screw and shifter. (Fig. 1.4)

(Manual transmission) Pull up on the shifter knob to remove it.
5. Remove (4) 7mm screws securing the shifter bezel. Pull outward on the two clips below to release it. Disconnect the light from the panel (if equipped) and remove the shifter bezel. Disconnect the center console wiring harness (A), located at the back of the shifter. (Fig. 1.5)
6. Remove (2) Philips screws at the front of the center console (one on each side, near the junction of the radio/climate area). (Fig. 1.6)
7. Remove (4) Philips screws on the the rear sides the console. Remove the rear cover of the center console by gently releasing the clips that secure it. (Fig. 1.7)
8. Remove (2) Philips screws at the rear base of the center console. (Fig. 1.8)
9. Remove the center console cover by pulling upward and lifting it over the parking brake. (Fig. 1.9)

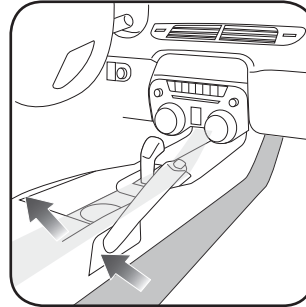

Fig. 1.3

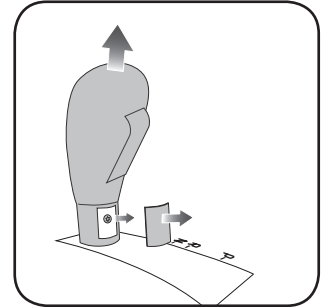

Fig. 1.4

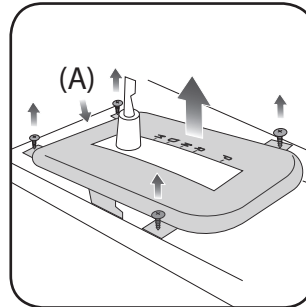

Fig. 1.5

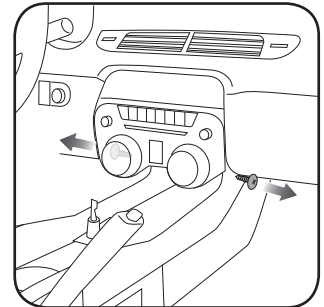

Fig. 1.6

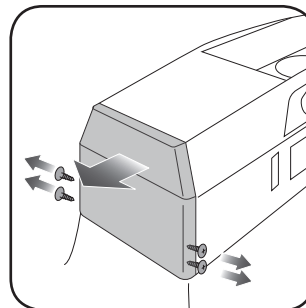

Fig. 1.7

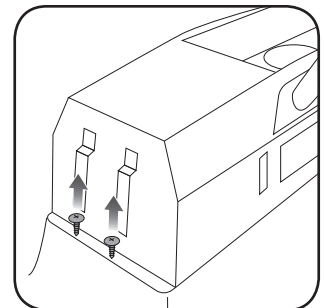

Fig. 1.8

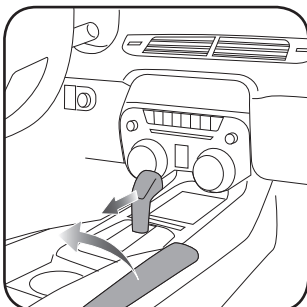

Fig. 1.1

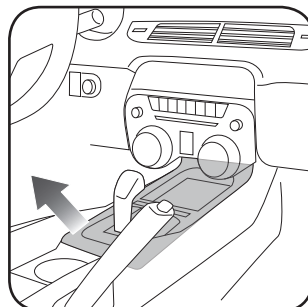

Fig. 1.2

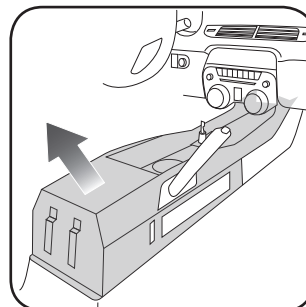

Fig. 1.9

INSTALLATION INSTRUCTIONS P2 / 2

DASH DISASSEMBLY (Radio removal)

1. Remove (2) 7mm screws securing the bottom of the radio bezel. (Fig. 2.1)
2. Using a panel tool, gently release the clips securing the radio bezel to the dash. Disconnect the wiring harness on the back of the OEM panel. (Fig. 2.1)
3. Remove (4) 7mm screws holding the OEM radio in the dash. Unclip the radio and remove it. (Fig. 2.2)

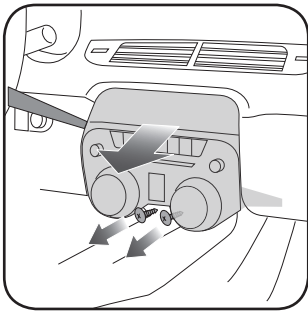

Fig. 2.1

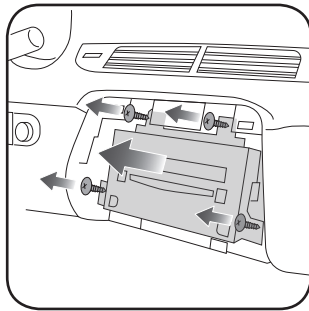

Fig. 2.2

RADIO INSTALLATION/MAKE CONNECTIONS

Unbox the aftermarket radio. Install the metal brackets provided with the CAM1 kit to the aftermarket radio using the screws supplied with the aftermarket radio. (Fig. 2.3)

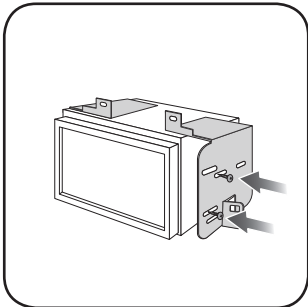

Fig. 2.3

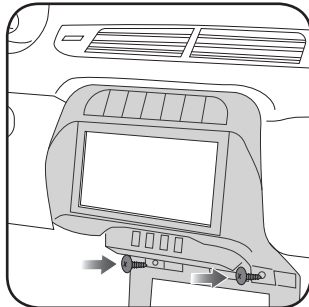

Fig. 2.4

(refer to wiring diagram)

1. If using head unit adapter (sold separately), connect HRR-CAM1 harness to adapter and skip to step 2.

Locate aftermarket radio's main harness. Cut and remove the black 20 pin connector from the HRR-CAM1 T-harness and connect the wires, shown in the wiring diagram, from aftermarket radio main harness to the HRR-CAM1 T-harness and match the wire functions.

Note: only connect purple/white wire to radio reverse input or module damage will occur.

2. Plug the backup camera cable into the factory harness (if applicable).
3. **With factory amplifier:** Connect the HRR-CAM1 8 pin WHITE connectors to the AMP adapter (PAD1 circuit).
Without factory amplifier: Leave the 8-pin white connectors on harness connected to each other.
4. Connect the CAM1 T-harness to the factory radio harness.
5. Plug the OBD2 connector into the OBD2 port of the vehicle, located under the driver side dash.
6. Plug the harnesses into the aftermarket radio. Plug the data cable to the data port of the aftermarket radio. Insert the audio cable into the iDataLink 3.5mm audio jack of the aftermarket radio (labeled iDataLink. If there is no iDataLink audio input, connect to AUX). Plug the backup camera RCA into the aftermarket radio (if applicable).

Note: When using a Pioneer radio, please ensure that there is nothing plugged into the W/R port of the radio.

7. Connect all harnesses to the Maestro RR module.
8. Insert the radio into the dash and secure the metal brackets with (4) 7mm screws removed during disassembly.
9. Connect the white 6-pin harness to the button bar of the dash kit.
10. Press the CAM1 bezel into place and secure it with the (2) 7mm screws. Test your installation before completely re-assembling the vehicle. (Fig. 2.4)

WIRING DIAGRAM *without an Amplifier*

**DASH KIT WITH HRR-CAM1 HARNESS
(HEAD UNIT ADAPTER READY KIT)**

STEP 1

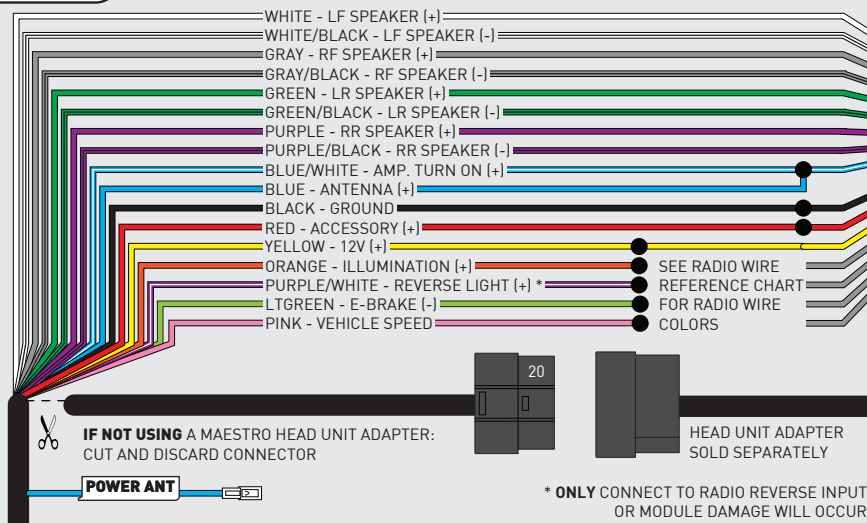

STEP 6

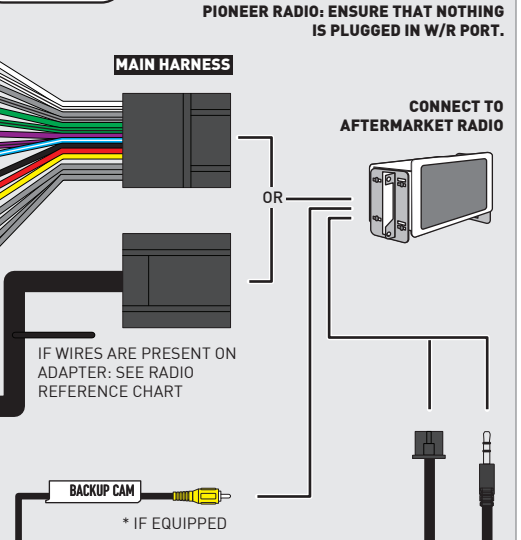

STEP 2



STEP 3



STEP 4

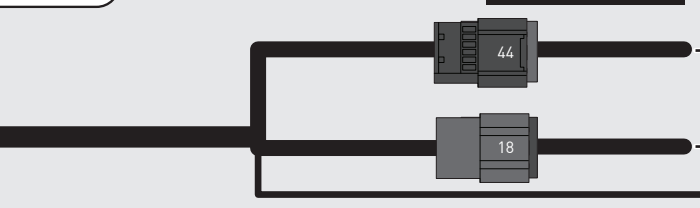

STEP 5

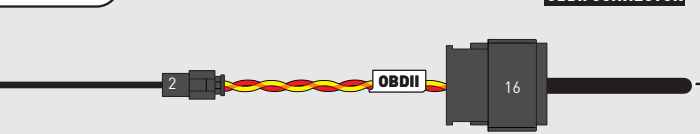

STEP 9

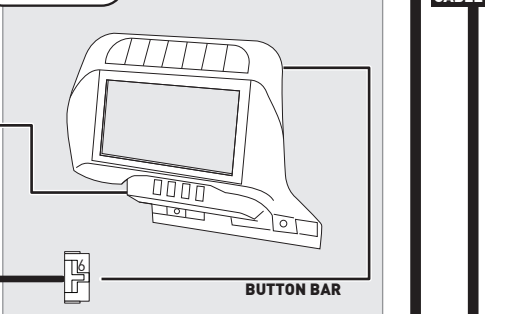

STEP 7

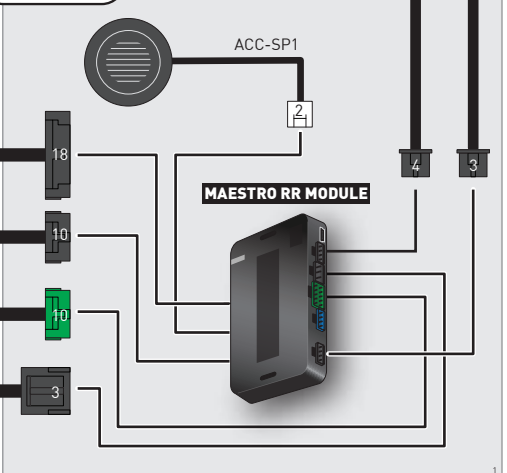

NOT REQUIRED

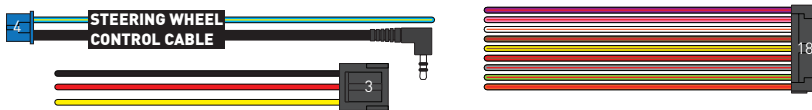

RADIO WIRE REFERENCE CHART

CAM1 T-harness Wire Description	Polarity	Wire Color on Maestro T-Harness	Wire Color on Alpine cable	Wire Color on Kenwood/ JVC cable	Wire Color on Pioneer cable	Wire Color on Sony cable
Illumination	(+)	Orange	N/A	Orange/White	Orange/White	Orange
Reverse Light*	(+)	Purple/White	Orange/White	Purple/White	Purple/White	Purple/White
E-Brake	(-)	Lt Green	Yellow/Blue	Lt Green	Lt Green	Lt Green
VSS (vehicle speed sensor)	(DATA)	Pink	Green/White	Pink	Pink	N/A
Power Antenna	(+)	Blue	Blue	Blue	Blue/White	Blue or Blue/White

Head unit adapter wiring (optional accessory, sold separately)

ACC-HU-ALP1 Wire Description	Polarity	Wire Color on Adapter	Alpine Radio
VSS (vehicle speed sensor)	(DATA)	Green/White	Green/White

ACC-HU-KEN1 Wire Description	Polarity	Wire Color on Adapter	Kenwood Radio
CAM	(+)	Green/Red	Refer to camera/radio manual
CAM	(-)	Green/White	Refer to camera/radio manual
Steering Wheel Controls	(DATA)	Blue/Yellow	n/a

ACC-HU-KEN2 Wire Description	Polarity	Wire Color on Adapter	Kenwood Radio
E-Brake	(-)	LtGreen	LtGreen
Reverse Light*	(+)	Purple/White	Purple/White
Steering Wheel Controls	(DATA)	Blue/Yellow	n/a

* Reverse light wire: Only connect to radio or module damage will occur.

MODULE DIAGNOSTICS



LED 1 Module/Firmware status	LED 2 (RR2) Bluetooth activity	LED STATUS	DIAGNOSTIC
● or ●		RED or GREEN flashing	LED flashes 1 or more times, either red or green, when a steering wheel button is pressed : normal operation.
●		1 RED flash	Module has no firmware. Flash module using Weblink Desktop and log in. Do <u>NOT</u> use DEMO MODE.
●		2 RED flashes	Problem detected. Consult troubleshooting table.
●		1 GREEN flash	After radio boots up : Normal operation.
	●	3 GREEN flashes	Bluetooth is activated. Turns off after one minute: Normal operation.
●	●	OFF	Normal operation (inactive).

VIDEO HELP		Installation, product information, vehicle specific videos.
VERIFY FLASH		Last flash information, steering control configuration, vehicle information.
WEBLINK		Software to program module.

TROUBLESHOOTING TABLE

PROBLEM	SOLUTION
Gauges do not work, radio shows OBD2 Error 1 or Error 2.	<p>Ensure OBDII connector is securely attached to the OBD2 connector of the vehicle.</p> <p>If you hardwired connections at the OBDII, check connections at the OBDII connector. Make sure the RED/BROWN wire is on PIN 6 and the YELLOW/BROWN wire is connected to PIN 14 of the OBDII connector. Do not use T-Taps. Soldering or military splicing methods are recommended.</p> <p>If anything else is connected to the OBD2 or CAN wires of vehicle (programmer, throttle controller, insurance tracker, etc.) try unplugging it to see if gauges work. If gauges work without it installed, call tech support for options.</p> <p>Reset the RR.</p>
The light on the Maestro is blinking RED TWICE and the radio IS turning on.	<p>Ensure the 4-pin data cable is connected between the radio and the RR, and that it is plugged into the black port on the Maestro RR. The red and blue ports on the RR should be empty.</p> <p>Make sure the correct radio model and serial number were entered during the flash. Verify the radio's serial number entered during the flash matches what is listed on the radio screen. This can be found in the settings of the radio, listed as Device Id, Device Number, or Serial Number.</p>
The light on the Maestro is blinking RED TWICE but radio is NOT turning on.	<p>If installing a modular radio and it is not turning on, ensure the screen is secured and any trim pieces on the radio have been installed fully. Not installing these fully will prevent radio from powering up and show a 2x red error as well.</p> <p>Test red and yellow wires for DC voltage at radio using a multimeter. Contact support if no voltage on red or yellow.</p>
Audio is very quiet or very loud.	<p>Non amplified vehicles: ensure the PAD1 AMP adapter is NOT plugged in between the white 8 pin plugs.</p> <p>Amplified vehicles: ensure the PAD1 AMP adapter IS plugged in between the white 8 pin plugs.</p>

MAESTRO RR RESET PROCEDURE:

Turn the key to the OFF position, then disconnect all connectors from the module.

Press and hold the module's programming button and connect all the connectors back to the module. Wait, the module's LED will flash RED rapidly (this may take up to 10 seconds).

Release the programming button. Wait, the LED will turn solid GREEN for 2 seconds to show the reset was successful.

TECHNICAL ASSISTANCE

Phone: 1-866-427-2999

Email: maestro.support@idatalink.com

IMPORTANT: To ensure proper operation, the aftermarket radio needs to have the latest firmware from the manufacturer. Please visit the radio manufacturer's website and look for any updates pertaining to your radio.