

BLADE

SERIES

Automotive Data Solutions Inc.

INSTALL GUIDE

BLADE-AL(DL)-NI8-EN

NI8

AVAILABLE FOR: ADS-BLADE AL

Rev. Date: April 13, 2023

Doc. No.: ##82110##

PATENT NO. US 8,856,780 CA 2759622

PLEASE VISIT WWW.IDATALINK.COM FOR COMPLETE PRODUCT DETAILS

The brand names and logos found in this guide are property of their respective owners. Automotive Data Solutions Inc. © 2023



I N F I N I T I

NISSAN

TERMS OF USE: Automotive Data Solutions Inc. ("ADS") products are strictly intended for installation by Certified Technicians who are employed by a registered business specialized in the installation of automotive aftermarket electronics products. Prior to beginning installation of an ADS product in a vehicle, it is the Certified Technician's responsibility to review the most current Product Guide, Install Guide and vehicle-specific notes available in Weblink®. ADS is not responsible for any damages whatsoever, including but not limited to any consequential damages, incidental damages, damages for loss of time, loss of earnings, loss of profit, commercial loss, loss of economic opportunity and the like that may or may not have resulted from the use, misuse, improper installation or operation of its products. Purchasers sole contractual remedy is refund of the purchase price of the ADS product(s). ADS reserves itself the right to suspend any Weblink® account without notice and decline to offer technical support to non-Certified Technicians, non-compliant Certified Technicians or end users.



INSTALL TYPE SELECTION - 1 OF 1

FEATURES

NOTE

I On the remote starter, configure the feature LOCK AFTER SHUTDOWN, to control RAP/autolight shutdown.

MAKE	MODEL	YEAR	INSTALL TYPE	FEATURES										
				DATA IMMOBILIZER BYPASS	SECURE TAKEOVER	A/M ALARM CTRL FROM OEM REMOTES	A/M RS CTRL FROM OEM REMOTES	PUSH TO START CTRL	DOOR STATUS OUTPUT	TRUNK STATUS OUTPUT	BRAKE PEDAL STATUS OUTPUT	TACHOMETER OUTPUT	E-BRAKE OUTPUT	
NISSAN	Altima PTS AT	19-22	5	•	•	•	•	•	•	•	•	•	•	•
	Qashqai PTS AT	17-23	2	•	•	•	•	•	•	•	•	•	•	•
	Rogue PTS AT	14-16	1	•	•	•	•	•	•	•	•	•	•	•
	Rogue PTS AT	17	2	•	•	•	•	•	•	•	•	•	•	•
	Rogue PTS AT	18-20	3	•	•	•	•	•	•	•	•	•	•	•
	Rogue Sport PTS AT	17-22	2	•	•	•	•	•	•	•	•	•	•	•
INFINITI	QX50 PTS AT	19-21	4	•	•	•	•	•	•	•	•	•	•	

Patent No. US 8,856,780 CA 2759622

Page 3 of 16

BLADE-AL(DL)-NI8-EN

Doc. No.: ##82110## 20230413

COMPONENT LOCATOR

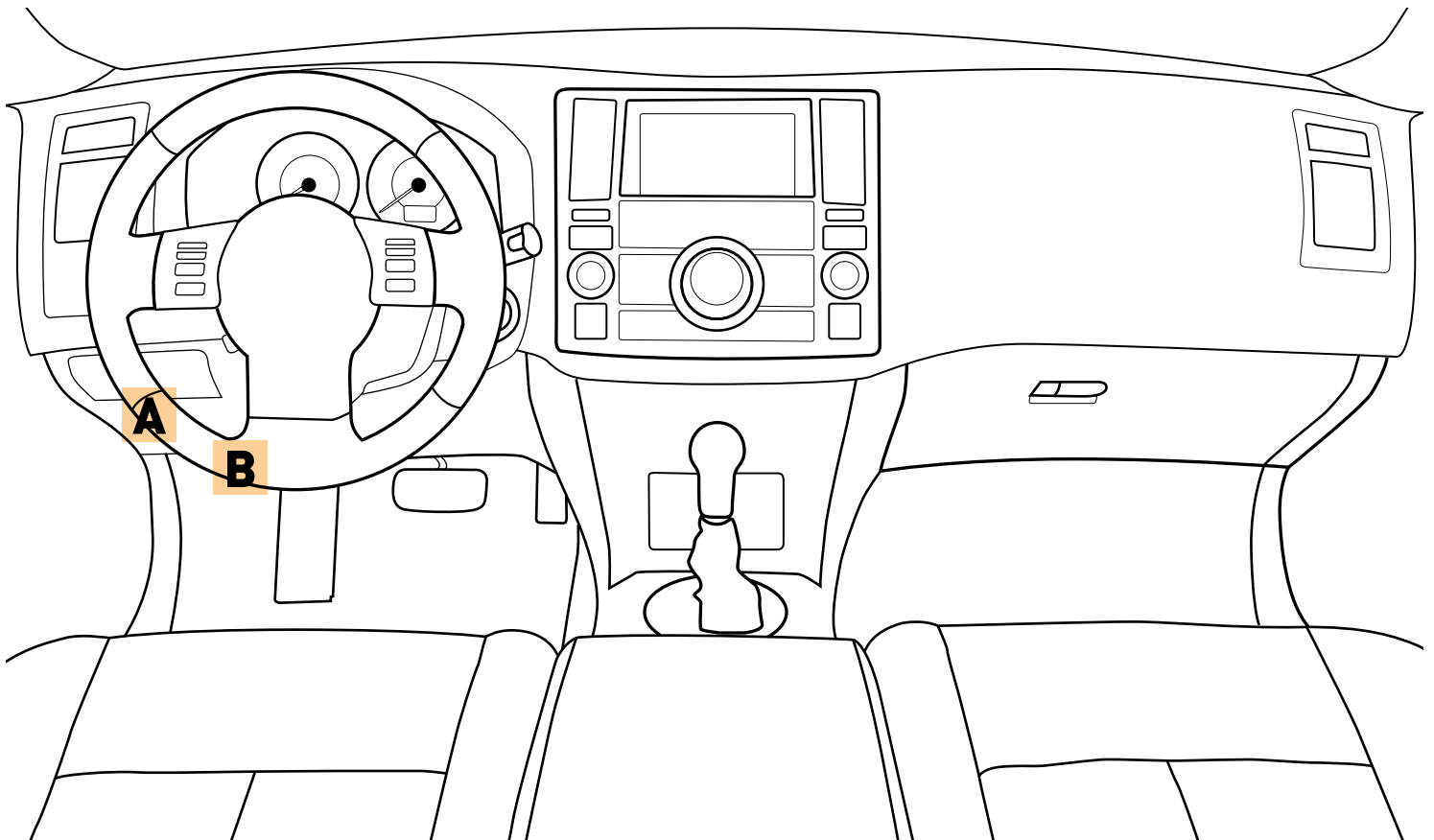
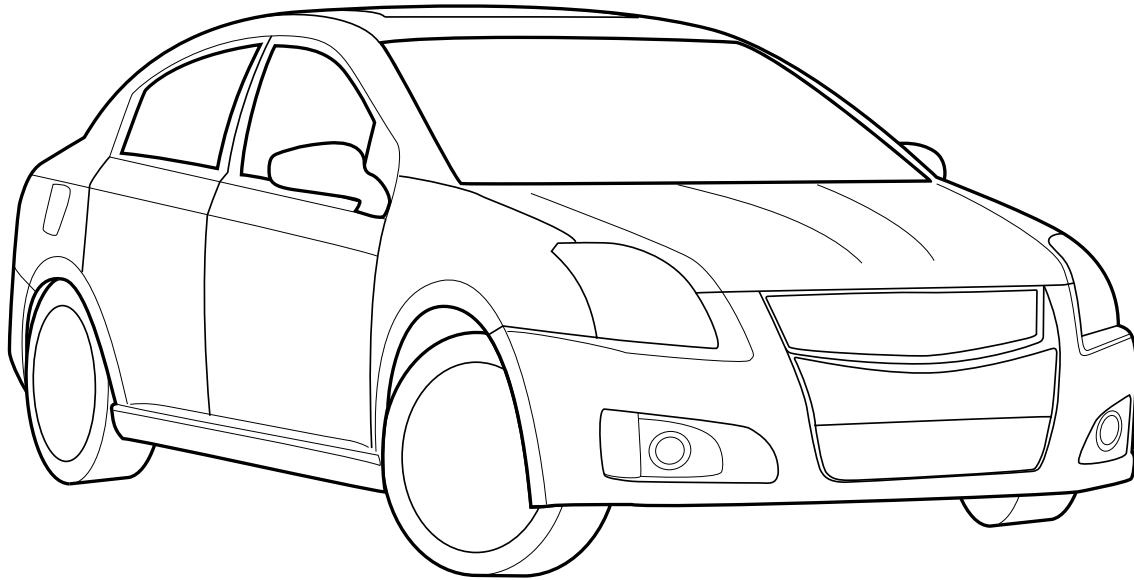

TYPE 1 - WIRE CROSS REFERENCE CHART - 1 OF 1

MAKE	MODEL	YEAR	WIRE DESCRIPTION	CONNECTOR NAME	CONNECTOR COLOR	CONNECTOR TYPE	POSITION	WIRE COLOR	POLARITY	MODULE LOCATION	COMPONENT LOCATOR
NISSAN	Rogue PTS AT	14-16	CanH	OBDII	White	16 pin	06	Blue	(DATA)	At OBDII connector	B
			CanL	OBDII	White	16 pin	14	Pink	(DATA)	At OBDII connector	B
			PTS	M19	Black	40 pin	09	Yellow	(-)	At BCM	A
			Ignition	OBDII	White	16 pin	08	Yellow	(+)	At OBDII connector	B
			12V	OBDII	White	16 pin	16	White	(+)	At OBDII connector	B
			Unlock	M19	Black	40 pin	13	Pink	(-)	At BCM	A
			Lock	M19	Black	40 pin	12	Brown	(-)	At BCM	A
			Power Liftgate	~	Green	08 pin	06	LtGreen	(-)	At switch, on lower dash panel	A
			Ground	OBDII	White	16 pin	04	Black	(-)	At OBDII connector	B
			Negative Starter	E29	Black	24 pin	19	Green	(-)	At BCM	A
			Negative Ignition 1	M18	Gray	40 pin	27	Yellow	(-)	At BCM	A
			Negative Ignition 2	M18	Gray	40 pin	28	LtPurple/White or Green/White	(-)	At BCM	A
Negative Ignition 3	M18	Gray	40 pin	25	Brown	(-)	At BCM	A			

TYPE 1 - WIRING DIAGRAM - 1 OF 1

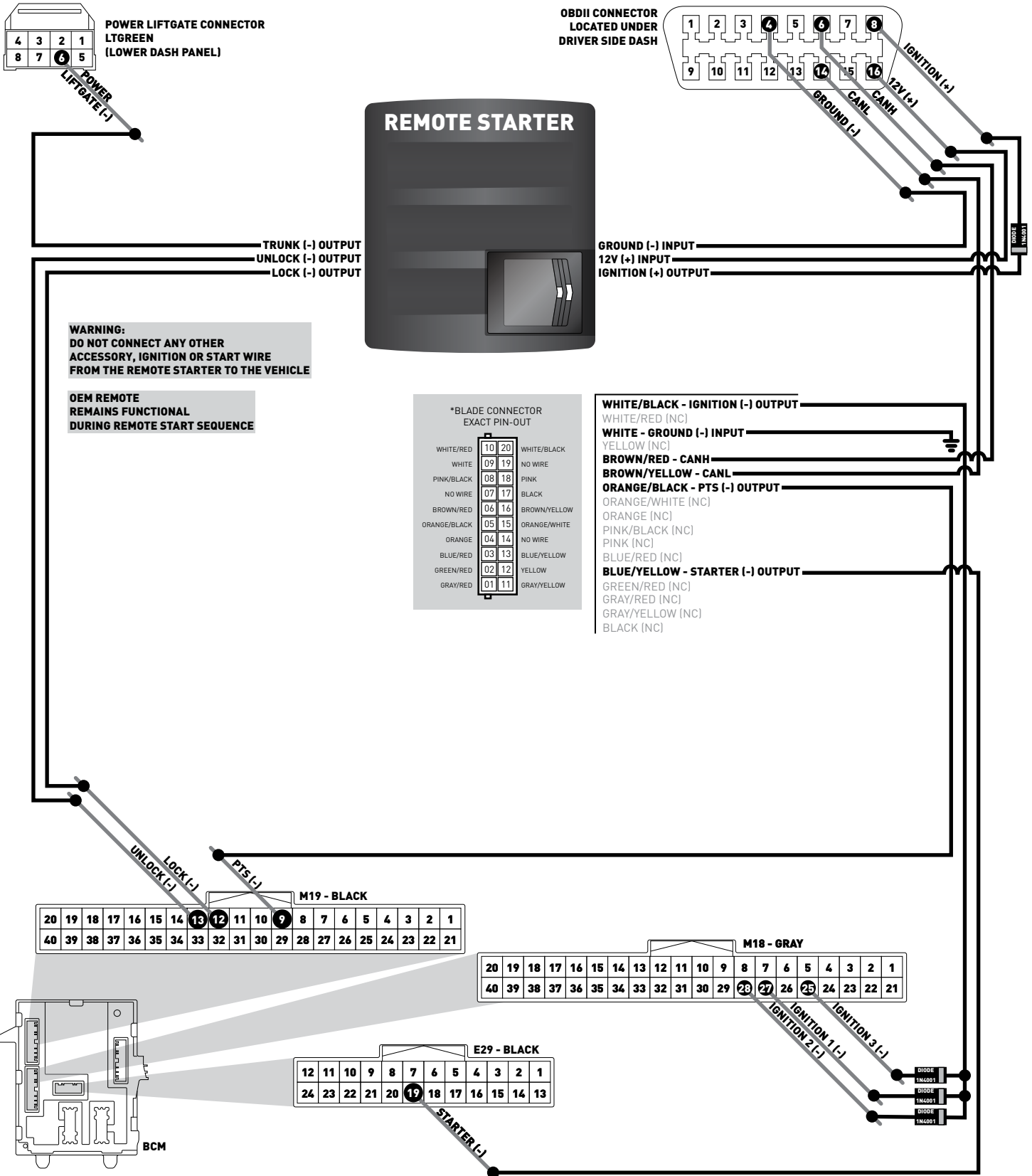

TYPE 2 - WIRE CROSS REFERENCE CHART - 1 OF 1

MAKE	MODEL	YEAR	WIRE DESCRIPTION	CONNECTOR NAME	CONNECTOR COLOR	CONNECTOR TYPE	POSITION	WIRE COLOR	POLARITY	MODULE LOCATION	COMPONENT LOCATOR
NISSAN	Qashqai PTS AT	17-23	CanH	~	Green	40 pin	20	Blue or Lavender/Blue	[DATA]	At BCM	A
			CanL	~	Green	40 pin	40	Pink or Lavender/Pink	[DATA]	At BCM	A
			PTS	M19	Black	40 pin	09	Red	[-]	At BCM	A
			Ignition	OBDII	White	16 pin	08	Yellow	[+]	At OBDII connector	B
			12V	OBDII	White	16 pin	16	White	[+]	At OBDII connector	B
			Unlock	M19	Black	40 pin	13	Pink	[-]	At BCM	A
			Lock	M19	Black	40 pin	12	Brown	[-]	At BCM	A
			Power Liftgate	~	Green	08 pin	06	LtGreen	[-]	At switch, on lower dash panel	A
			Ground	OBDII	White	16 pin	04	Black	[-]	At OBDII connector	B
			Negative Starter	E29	Black	24 pin	19	Blue	[-]	At BCM	A
			Negative Ignition 1	M18	Gray	40 pin	27	Lavender/Green	[-]	At BCM	A
			Negative Ignition 2	M18	Gray	40 pin	28	Lavender/Blue	[-]	At BCM	A
			Negative Ignition 3	M18	Gray	40 pin	25	Lavender/Pink	[-]	At BCM	A
	Rogue PTS AT	17	CanH	~	Green	40 pin	20	Blue	[DATA]	At BCM	A
			CanL	~	Green	40 pin	40	Pink	[DATA]	At BCM	A
			PTS	M19	Black	40 pin	09	Yellow	[-]	At BCM	A
			Ignition	OBDII	White	16 pin	08	Yellow	[+]	At OBDII connector	B
			12V	OBDII	White	16 pin	16	White	[+]	At OBDII connector	B
			Unlock	M19	Black	40 pin	13	Pink	[-]	At BCM	A
			Lock	M19	Black	40 pin	12	Brown	[-]	At BCM	A
			Power Liftgate	~	Green	08 pin	06	LtGreen	[-]	At switch, on lower dash panel	A
			Ground	OBDII	White	16 pin	04	Black	[-]	At OBDII connector	B
			Negative Starter	E29	Black	24 pin	19	Green	[-]	At BCM	A
			Negative Ignition 1	M18	Gray	40 pin	27	Yellow	[-]	At BCM	A
			Negative Ignition 2	M18	Gray	40 pin	28	Lavender/White or Green/White	[-]	At BCM	A
			Negative Ignition 3	M18	Gray	40 pin	25	Lavender/Pink	[-]	At BCM	A
	Rogue Sport PTS AT	17-22	CanH	~	Green	40 pin	20	Blue or Lavender/Blue	[DATA]	At BCM	A
			CanL	~	Green	40 pin	40	Pink or Lavender/Pink	[DATA]	At BCM	A
			PTS	M19	Black	40 pin	09	Red	[-]	At BCM	A
			Ignition	OBDII	White	16 pin	08	Yellow	[+]	At OBDII connector	B
			12V	OBDII	White	16 pin	16	White	[+]	At OBDII connector	B
			Unlock	M19	Black	40 pin	13	Pink	[-]	At BCM	A
			Lock	M19	Black	40 pin	12	Brown	[-]	At BCM	A
			Power Liftgate	~	Green	08 pin	06	LtGreen	[-]	At switch, on lower dash panel	A
			Ground	OBDII	White	16 pin	04	Black	[-]	At OBDII connector	B
			Negative Starter	E29	Black	24 pin	19	Blue	[-]	At BCM	A
Negative Ignition 1			M18	Gray	40 pin	27	Lavender/Green	[-]	At BCM	A	
Negative Ignition 2			M18	Gray	40 pin	28	Lavender/Blue	[-]	At BCM	A	
Negative Ignition 3			M18	Gray	40 pin	25	Lavender/Pink	[-]	At BCM	A	

TYPE 2 - WIRING DIAGRAM - 1 OF 1

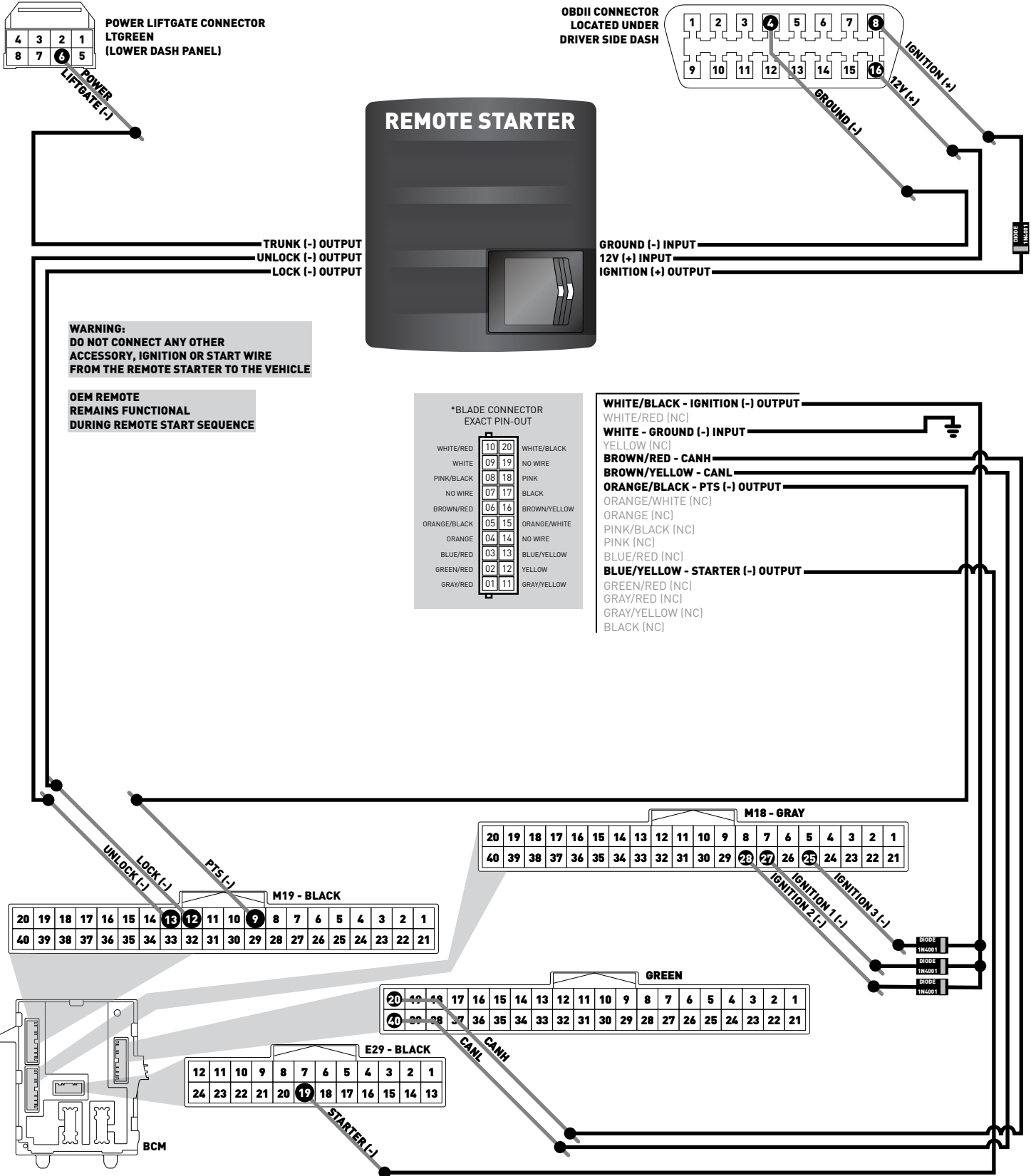

TYPE 3 - WIRE CROSS REFERENCE CHART - 1 OF 1

MAKE	MODEL	YEAR	WIRE DESCRIPTION	CONNECTOR NAME	CONNECTOR COLOR	CONNECTOR TYPE	POSITION	WIRE COLOR	POLARITY	MODULE LOCATION	COMPONENT LOCATOR
NISSAN	Rogue PTS AT	18-20	CanH	~	Green	40 pin	20	Blue	(DATA)	At BCM	A
			CanL	~	Green	40 pin	40	Pink	(DATA)	At BCM	A
			PTS	M19	Black	40 pin	09	Yellow	(-)	At BCM	A
			Ignition	OBDII	White	16 pin	08	Yellow	(+)	At OBDII connector	B
			12V	OBDII	White	16 pin	16	White	(+)	At OBDII connector	B
			Unlock	M19	Black	40 pin	13	Pink	(-)	At BCM	A
			Lock	M19	Black	40 pin	12	Brown	(-)	At BCM	A
			Power Liftgate	~	Green	08 pin	06	LtGreen	(-)	At switch, on lower dash panel	A
			Ground	OBDII	White	16 pin	04	Black	(-)	At OBDII connector	B
			Negative Starter	E29	Black	24 pin	19	Green	(-)	At BCM	A
			Negative Ignition 1	M18	Gray	40 pin	27	Yellow	(-)	At BCM	A
			Negative Ignition 2	M18	Gray	40 pin	28	Lavender/White or Green/White	(-)	At BCM	A
Negative Ignition 3	M18	Gray	40 pin	25	Brown	(-)	At BCM	A			

TYPE 3 - WIRING DIAGRAM - 1 OF 1

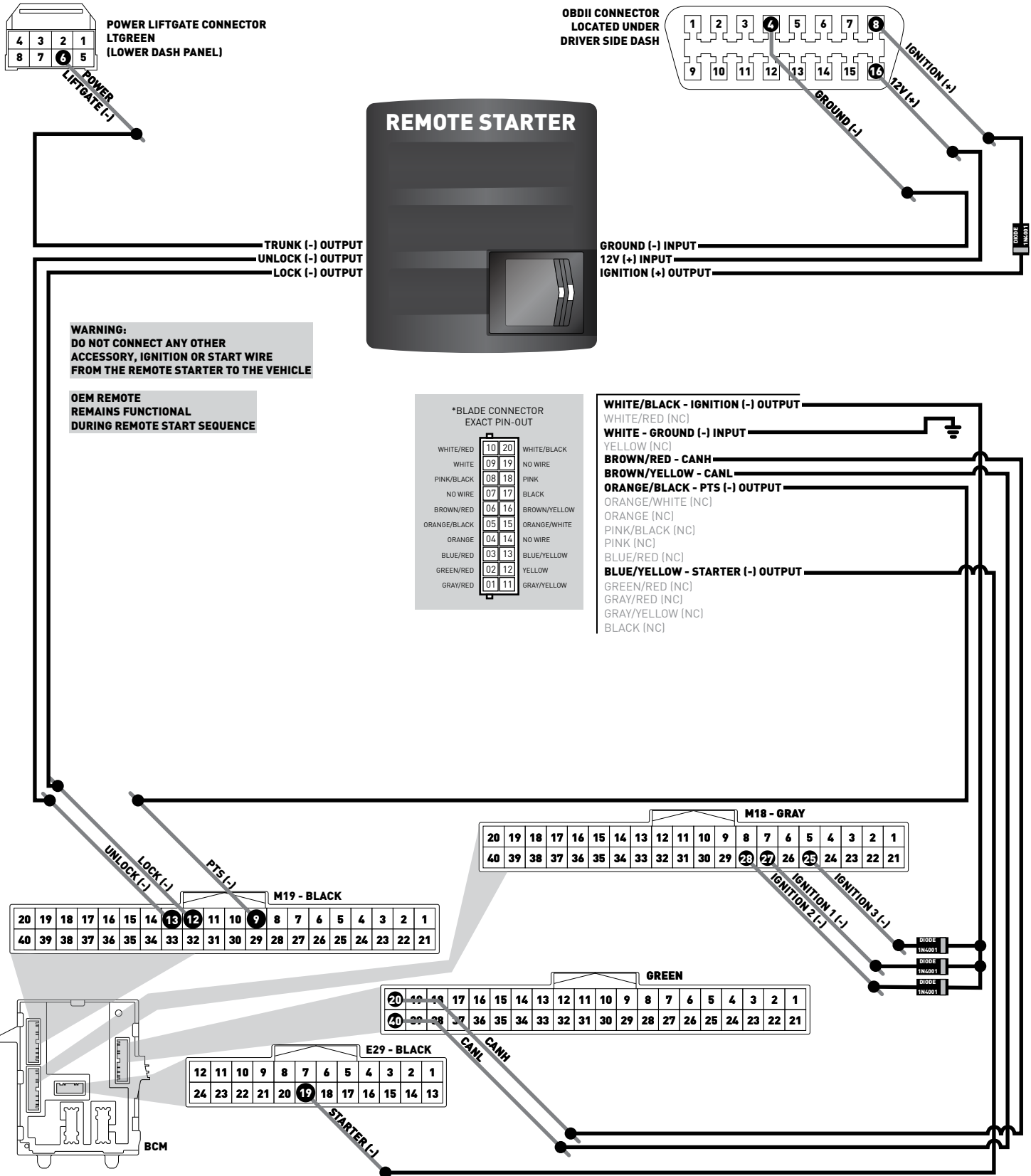

TYPE 4 - WIRE CROSS REFERENCE CHART - 1 OF 1

MAKE	MODEL	YEAR	WIRE DESCRIPTION	CONNECTOR NAME	CONNECTOR COLOR	CONNECTOR TYPE	POSITION	WIRE COLOR	POLARITY	MODULE LOCATION	COMPONENT LOCATOR
INFINITI	QX50 PTS AT	19-21	CanH	~	Green	40 pin	20	Blue	(DATA)	BCM	A
			CanL	~	Green	40 pin	40	Pink	(DATA)	BCM	A
			PTS	M19	Black	40 pin	09	Yellow	(-)	BCM	A
			Ignition	OBDII	White	16 pin	08	White	(+)	OBDII connector	B
			12V	OBDII	White	16 pin	16	Yellow	(+)	OBDII connector	B
			Unlock	M19	Black	40 pin	21	Pink	(-)	BCM	A
			Lock	M19	Black	40 pin	01	Brown	(-)	BCM	A
			Power Liftgate	~	White	16 pin	04	White	(-)	At switch, on lower dash panel	A
			Ground	OBDII	White	16 pin	04	Black	(-)	OBDII connector	B
			Negative Starter	E29	Black	24 pin	19	Green	(-)	BCM	A
			Negative Ignition 1	M18	Gray	40 pin	27	Yellow	(-)	BCM	A
			Negative Ignition 2	M18	Gray	40 pin	28	White	(-)	BCM	A
			Negative Ignition 3	M18	Gray	40 pin	25	Brown	(-)	BCM	A
			Driver Door Pin	~	Green	40 pin	17	LtBlue	(-)	BCM	A

TYPE 4 - WIRING DIAGRAM - 1 OF 1

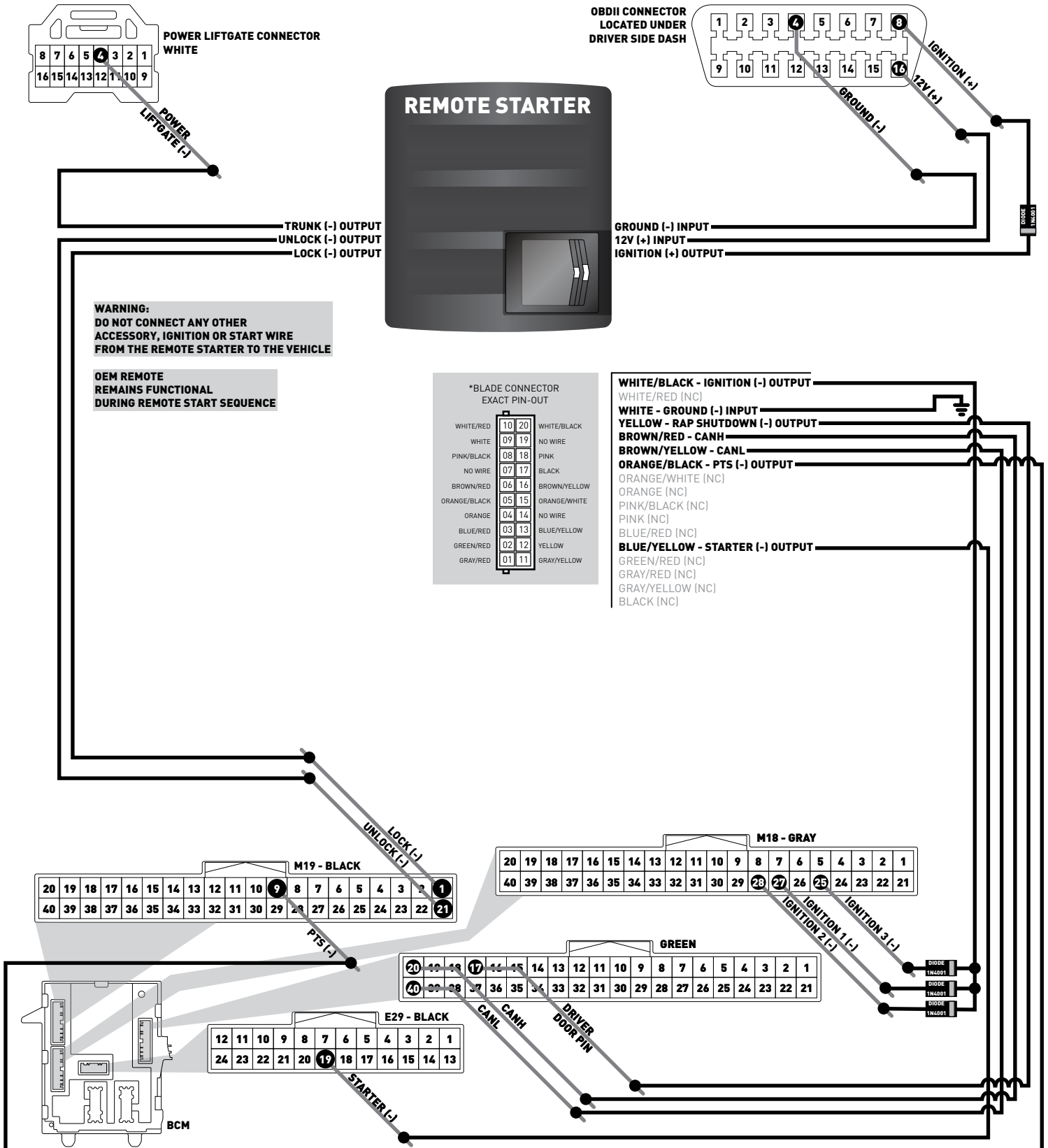

TYPE 5 - WIRE CROSS REFERENCE CHART - 1 OF 1

MAKE	MODEL	YEAR	WIRE DESCRIPTION	CONNECTOR NAME	CONNECTOR COLOR	CONNECTOR TYPE	POSITION	WIRE COLOR	POLARITY	MODULE LOCATION	COMPONENT LOCATOR
NISSAN	Altima PTS AT	19-22	CanH	~	Green	40 pin	20	Blue	(DATA)	BCM	A
			CanL	~	Green	40 pin	40	Pink	(DATA)	BCM	A
			PTS	M19	Black	40 pin	09	Yellow	(-)	BCM	A
			Ignition	OBDII	White	16 pin	08	Tan	(+)	OBDII connector	B
			12V	OBDII	White	16 pin	16	Blue	(+)	OBDII connector	B
			Unlock	M19	Black	40 pin	13	Empty or Pink	(-)	BCM	A
			Lock	M19	Black	40 pin	12	Empty or Brown	(-)	BCM	A
			Trunk release	~	Gray	04 pin	02	Brown	(-)	At switch, on lower dash panel	~
			Ground	OBDII	White	16 pin	04	Black	(-)	OBDII connector	B
			Negative Starter	E29	Black	24 pin	19	Red	(-)	BCM	A
			Negative Ignition 1	M18	Gray	40 pin	27	White	(-)	BCM	A
			Negative Ignition 2	M18	Gray	40 pin	28	White/LtGreen	(-)	BCM	A
			Negative Ignition 3	M18	Gray	40 pin	25	Brown	(-)	BCM	A

TYPE 5 - WIRING DIAGRAM - 1 OF 1

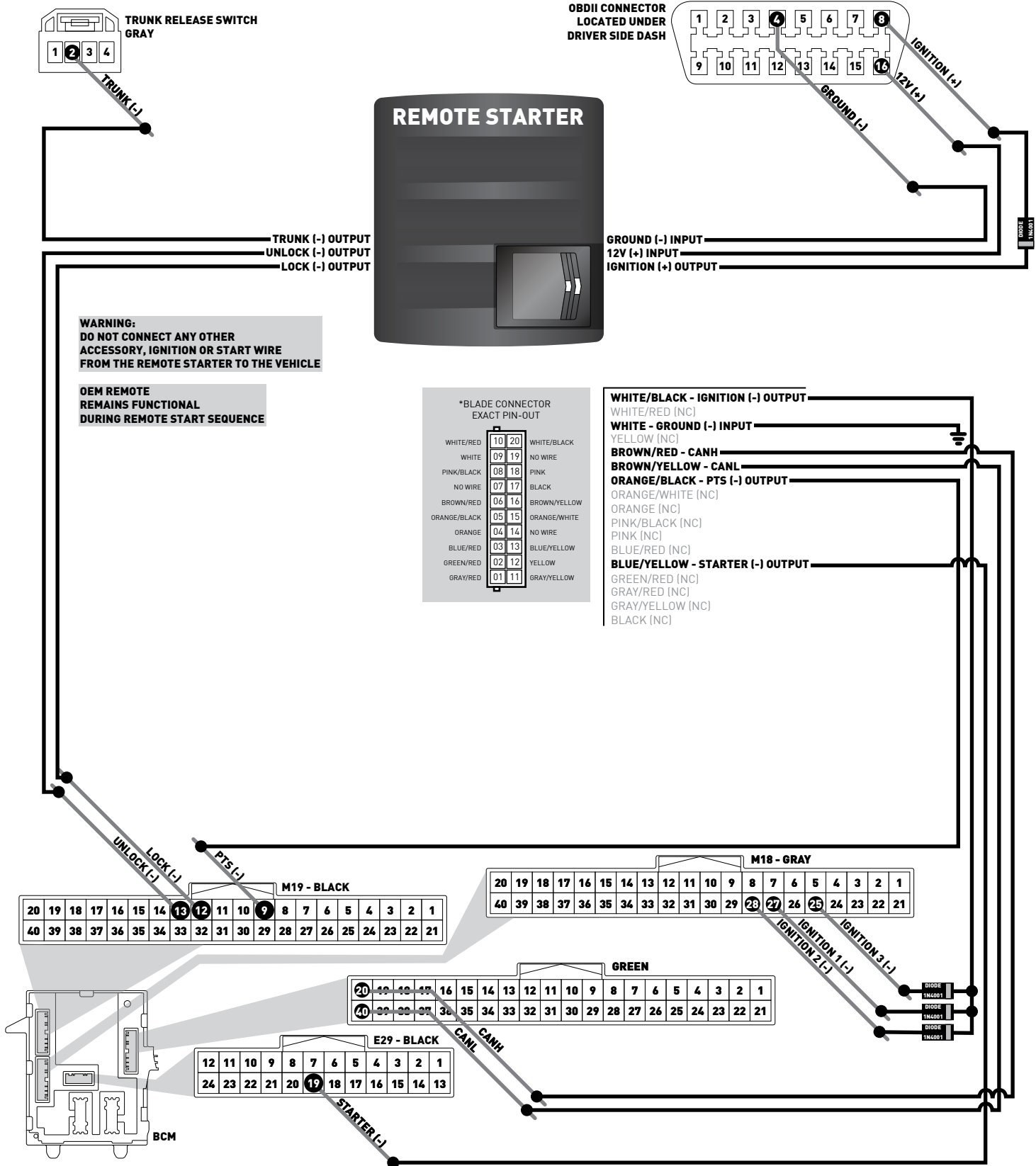

CARTRIDGE INSTALLATION

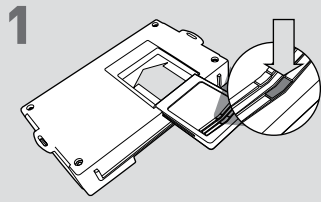

1 Slide cartridge into unit. Notice button under LED.

2

Ready for Module Programming Procedure.

MODULE PROGRAMMING PROCEDURE

1 OFF ACC **ON** START

Set ignition to ON position.

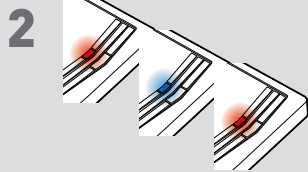

2 Wait, LED will turn solid RED, then solid BLUE for 1 second, then solid RED.

3 OFF ACC ON START

Set ignition to OFF position.



4 Wait, LED will turn OFF.

5 OFF ACC **ON** START

Set ignition to ON position.

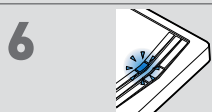

6 If LED flashes BLUE rapidly, proceed with step 7. If LED turns solid BLUE for 2 seconds, proceed with step 13.

7 OFF ACC ON START

Set ignition to OFF position.



8

WARNING:
Disconnect power last.
Disconnect module from vehicle.

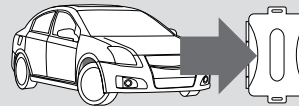

9

Connect module to computer and proceed with extended programming.

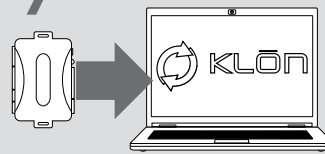

10

WARNING:
Connect power first.
Connect module to vehicle.

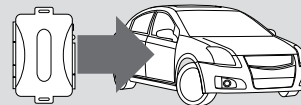

11 OFF ACC **ON** START

Set ignition to ON position.



12

Wait, LED will turn solid BLUE for 2 seconds.

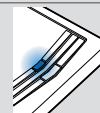

13 OFF ACC ON START

Set ignition to OFF position.



14

Module Programming Procedure completed.

IDENTIFY VEHICLE YEAR

1 Locate the Vehicle Identification Number (VIN), identify the 10th character then match it to its corresponding year.



A	1980	L	1990	Y	2000	A	2010	L	2020
B	1981	M	1991	1	2001	B	2011	M	2021
C	1982	N	1992	2	2002	C	2012	N	2022
D	1983	P	1993	3	2003	D	2013	P	2023
E	1984	R	1994	4	2004	E	2014	R	2024
F	1985	S	1995	5	2005	F	2015	S	2025
G	1986	T	1996	6	2006	G	2016	T	2026
H	1987	V	1997	7	2007	H	2017	V	2027
J	1988	W	1998	8	2008	J	2018	W	2028
K	1989	X	1999	9	2009	K	2019	X	2029

MODULE DIAGNOSTICS

LED STATUS	DIAGNOSTICS		
	DURING PROGRAMMING	DURING REMOTE START	WITH IGNITION OFF
Flashing RED	Missing/wrong information from firmware or vehicle	Incorrectly programmed	Incorrectly programmed or connected
Solid RED	Waiting for more vehicle information	Incorrectly programmed	Not programmed waiting for more vehicle information
Flashing BLUE	Additional steps required to complete programming	Correctly programmed and operational	False ground when running status from remote starter
Solid BLUE then OFF	Correctly programmed	Reset in progress	Reset in progress
OFF	No activity or already programmed	Invalid ground when running status from remote starter	At rest and ready for a remote start sequence

FACTORY RESET PROCEDURE

1 **DISCONNECT** cartridge from remote starter.

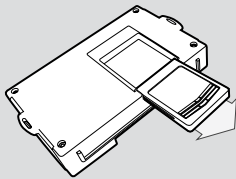

2 **PRESS AND HOLD** programming button while re-connecting cartridge to remote starter.

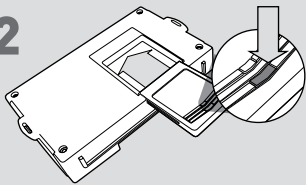

3

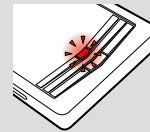

LED will flash red. Immediately **RELEASE** programming button.

4

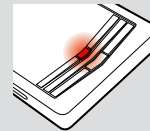

LED will turn solid red for 2 seconds.

RESET COMPLETED.

5

RECONNECT all connectors. Repeat programming procedure.



Failure to follow procedure may result with a DTC or a CHECK ENGINE error message.

WARNING: READ BEFORE REMOTE STARTING THE VEHICLE

IMPORTANT

- I All vehicle doors must be closed and locked prior to remote start sequence. Failure to comply will result in remote starter malfunction.

TAKE OVER PROCEDURE - PUSH TO START - TO THE VEHICLE OWNER

NOTE

- I All vehicle doors must be closed and locked prior to remote start sequence.



TIME RESTRICTION COMING UP !

1



Unlock vehicle door using OEM or after-market remote, or door request switch.

2

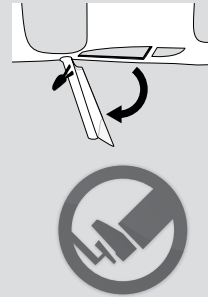

TIME RESTRICTION

Within 45 SECONDS from previous step:

Open vehicle door.
Enter vehicle.
Close vehicle door.

Press and release BRAKE pedal.

3

Take over procedure completed.



Failure to follow procedure will result in vehicle engine shutdown.