



Automotive Data Solutions Inc.

INSTALL GUIDE

FLC-AL(DL)-GM4-EN

GM4

AVAILABLE FOR: FLCAN

Rev. Date: April 07, 2017

Doc. No.: ##37797##

U.S. PATENT NO. 8,856,780

PLEASE VISIT WWW.FLASHLOGIC.COM FOR COMPLETE PRODUCT DETAILS

The brand names and logos found in this guide are property of their respective owners. Automotive Data Solutions Inc. © 2017

CHEVROLET

GMC

HUMMER

PONTIAC

SATURN

NOTICE: The manufacturer will accept no responsibility for any electrical damage resulting from improper installation of this product, be that either damage to the vehicle itself or to the installed device. This device must be installed by a certified technician. This guide has been written for properly trained technicians; a certain level of skill & knowledge is therefore assumed. Please review the Installation Guide carefully before beginning any work.

INSTALL TYPE SELECTION

MAKE	MODEL	YEAR	INSTALL TYPE	FEATURES										
				DATA IMMOBILIZER BYPASS	DATA/MUX ACCESSORY CTRL	DATA/MUX STARTER CTRL	ARM OEM ALARM	DISARM OEM ALARM	DOOR LOCK	DOOR UNLOCK	PRIORITY UNLOCK	TRUNK/HATCH RELEASE	RAP SHUTDOWN CTRL	
CHEVROLET	Classic*	04-05	2	•	•	•	•	•	•	•	•			•
	Colorado	04-07	3	•	•	•	•	•	•	•	•			•
	Colorado (US model)	08	3	•	•	•	•	•	•	•	•			•
	Colorado (Canadian model)	08	4	•	•	•	•	•	•	•	•			•
	Colorado	09-12	4	•	•	•	•	•	•	•	•			•
	Equinox	05-06	2	•	•	•	•	•	•	•	•			•
	Malibu	97-03	2	•	•	•	•	•	•	•	•			•
GMC	Canyon	04-07	3	•	•	•	•	•	•	•	•			•
	Canyon (US model)	08	3	•	•	•	•	•	•	•	•			•
	Canyon (Canadian model)	08	4	•	•	•	•	•	•	•	•			•
	Canyon	09-12	4	•	•	•	•	•	•	•	•			•
HUMMER	H3	06-08	3	•	•	•	•	•	•	•	•			•
	H3	09	4	•	•	•	•	•	•	•	•			•
ISUZU	I-280	05-06	3	•	•	•	•	•	•	•	•			•
	I-290	07-08	3	•	•	•	•	•	•	•	•			•
	I-290	09	4	•	•	•	•	•	•	•	•			•
	I-350	05-06	3	•	•	•	•	•	•	•	•			•
	I-370	07-08	3	•	•	•	•	•	•	•	•			•
	I-370	09	4	•	•	•	•	•	•	•	•			•
OLDSMOBILE	Cutlass	97-99	2	•	•	•	•	•	•	•			•	
PONTIAC	Torrent	06	2	•	•	•	•	•	•	•			•	
SATURN	Ion	03-07	1	•	•	•			•	•	•	•		
	L series	00-05	2	•	•	•	•	•	•	•	•			•
	Vue	02-07	2	•	•	•	•	•	•	•	•			•

*Same model generation as the 97-03 Malibu.

TYPE 1 - WIRE CROSS REFERENCE CHART

MAKE	MODEL	YEAR	WIRE DESCRIPTION	CONNECTOR NAME	CONNECTOR COLOR	CONNECTOR TYPE	POSITION	WIRE COLOR	POLARITY	MODULE LOCATION	COMPONENT LOCATOR
SATURN	Ion	03-07	Data	~	~	16 pin	02	Purple	(DATA)	OBDII connector	~
			Passlock	~	~	06 pin	05	White	~	Ignition switch	~
			Accessory	~	~	06 pin	04	Brown	(+)	Ignition switch	~
			Ignition	~	~	06 pin	03	DkBlue	(+)	Ignition switch	~

TYPE 1 - WIRING DIAGRAM

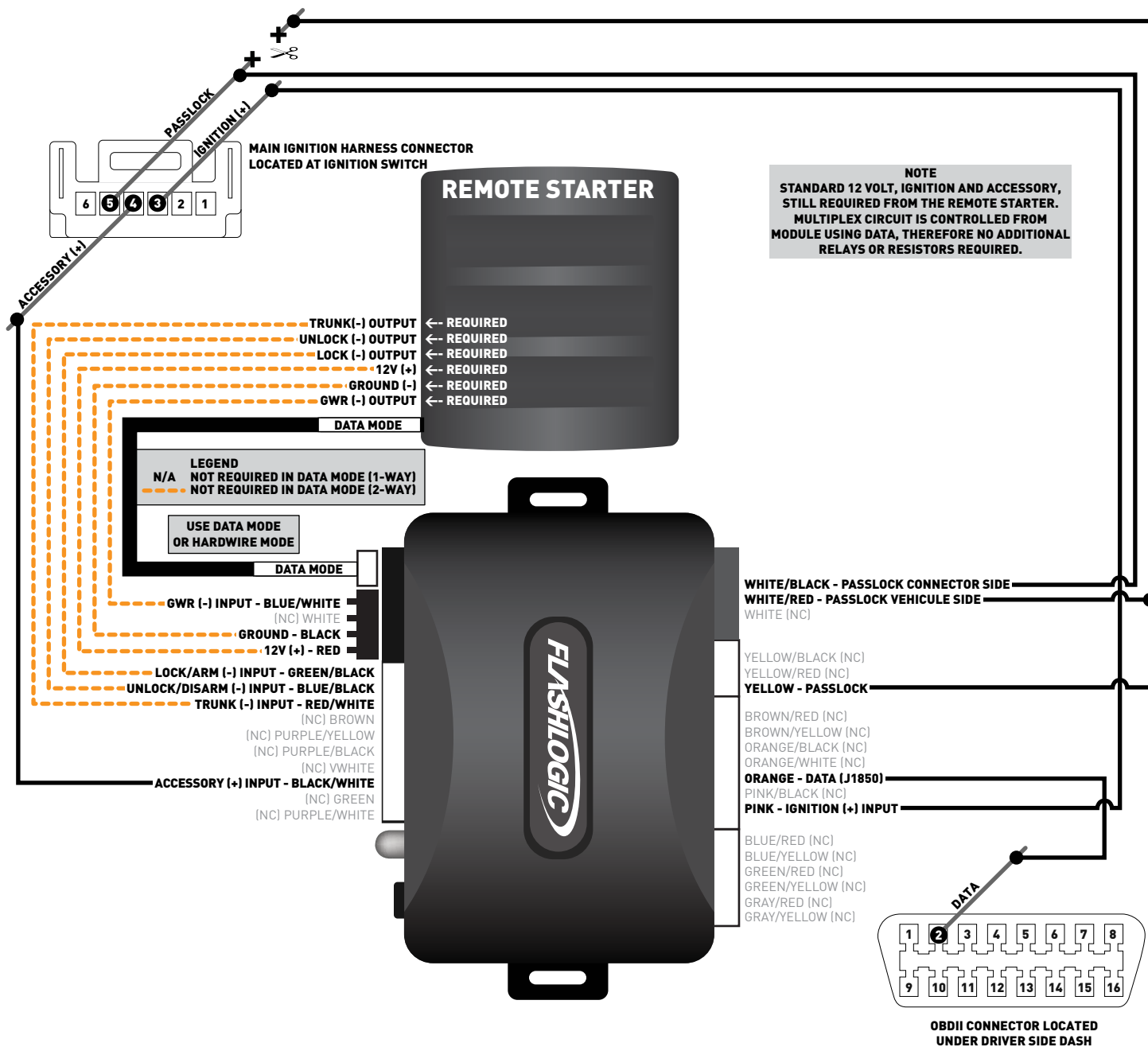

TYPE 2 - WIRE CROSS REFERENCE CHART

MAKE	MODEL	YEAR	WIRE DESCRIPTION	CONNECTOR NAME	CONNECTOR COLOR	CONNECTOR TYPE	POSITION	WIRE COLOR	POLARITY	MODULE LOCATION	COMPONENT LOCATOR	
CHEVROLET	Classic	04-05	Data	~	~	16 pin	02	Purple	(DATA)	OBDII connector	~	
			Ground	~	~	~	~	~	Black	(-)	Ignition switch	~
			Passlock (1 to 4 Volts)	~	~	~	~	~	Yellow	(+)	Ignition switch	~
			Keysense	~	~	~	~	~	LtGreen	(-)	Ignition switch	~
	Equinox	05-06	Data	~	~	16 pin	02	Purple	(DATA)	OBDII connector	~	
			Ground	~	~	~	~	~	Black	(-)	Ignition switch	~
			Passlock (1 to 4 Volts)	~	~	~	~	~	Yellow	(+)	Ignition switch	~
			Keysense	~	~	~	~	~	LtGreen	(-)	Ignition switch	~
	Malibu	97-03	Data	~	~	16 pin	02	Purple	(DATA)	OBDII connector	~	
			Ground	~	~	~	~	~	Black	(-)	Ignition switch	~
			Passlock (1 to 4 Volts)	~	~	~	~	~	Yellow	(+)	Ignition switch	~
			Keysense	~	~	~	~	~	LtGreen	(-)	Ignition switch	~
OLDS	Cutlass	97-99	Data	~	~	16 pin	02	Purple	(DATA)	OBDII connector	~	
			Ground	~	~	~	~	~	Black	(-)	Ignition switch	~
			Passlock (1 to 4 Volts)	~	~	~	~	~	Yellow	(+)	Ignition switch	~
			Keysense	~	~	~	~	~	LtGreen	(-)	Ignition switch	~
PONTIAC	Torrent	06	Data	~	~	16 pin	02	Purple	(DATA)	OBDII connector	~	
			Ground	~	~	~	~	~	Black	(-)	Ignition switch	~
			Passlock (1 to 4 Volts)	~	~	~	~	~	Yellow	(+)	Ignition switch	~
			Keysense	~	~	~	~	~	LtGreen	(-)	Ignition switch	~
SATURN	L series	00-05	Data	~	~	16 pin	02	Purple	(DATA)	OBDII connector	~	
			Ground	~	~	~	~	~	Black	(-)	Ignition switch	~
			Passlock (1 to 4 Volts)	~	~	~	~	~	Yellow	(+)	Ignition switch	~
			Keysense	~	~	~	~	~	LtGreen	(-)	Ignition switch	~
	Vue	02-07	Data	~	~	16 pin	02	Purple	(DATA)	OBDII connector	~	
			Ground	~	~	~	~	~	Black	(-)	Ignition switch	~
			Passlock (1 to 4 Volts)	~	~	~	~	~	Yellow	(+)	Ignition switch	~
			Keysense	~	~	~	~	~	LtGreen	(-)	Ignition switch	~

TYPE 2 - WIRING DIAGRAM

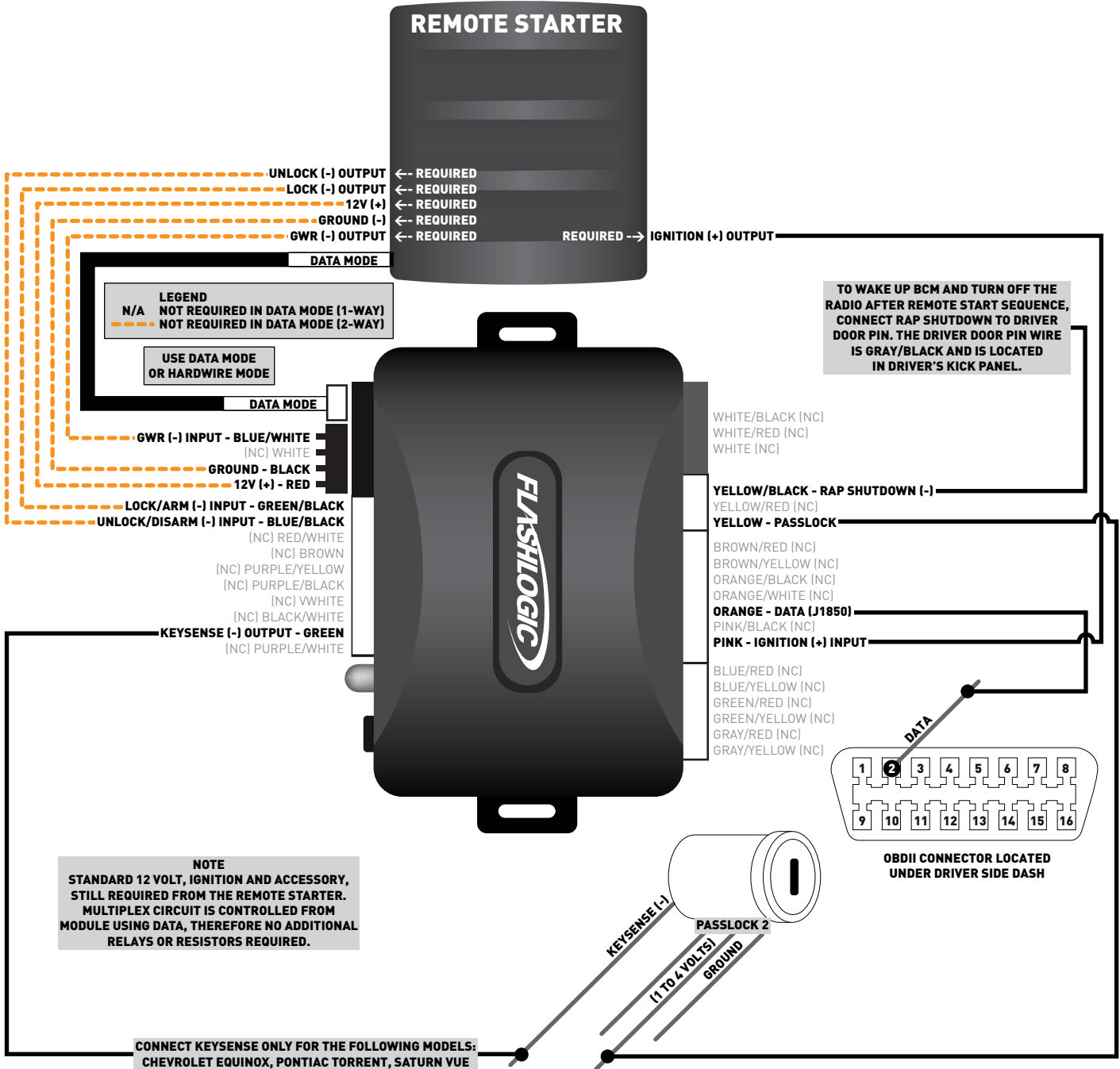

TYPE 3 - WIRE CROSS REFERENCE CHART - 1 OF 2

MAKE	MODEL	YEAR	WIRE DESCRIPTION	CONNECTOR NAME	CONNECTOR COLOR	CONNECTOR TYPE	POSITION	WIRE COLOR	POLARITY	MODULE LOCATION	COMPONENT LOCATOR
CHEVROLET	Colorado	04-07	Data	~	~	16 pin	02	Purple	(DATA)	OBDII connector	~
			Dome Light	~	Green	14 pin	11	Purple	(-)	Behind head light switch	~
			Door Pin	~	~	~	~	Gray/Black	(-)	Driver kick panel	~
			Passlock	~	~	06 pin	04	White/Blue or White	~	Ignition switch	~
			Accessory	~	~	06 pin	01	White/Red	(+)	Ignition switch	~
			Ignition	~	~	06 pin	03	White/Green	(+)	Ignition switch	~
			IPC Reference	~	~	06 pin	05	White/Yellow	~	Ignition switch	~
	Colorado (US model)	08	Data	~	~	16 pin	02	Purple	(DATA)	OBDII connector	~
			Dome Light	~	Green	14 pin	11	Purple	(-)	Behind head light switch	~
			Door Pin	~	~	~	~	Gray/Black	(-)	Driver kick panel	~
			Passlock	~	~	06 pin	04	White/Blue or White	~	Ignition switch	~
			Accessory	~	~	06 pin	01	White/Red	(+)	Ignition switch	~
			Ignition	~	~	06 pin	03	White/Green	(+)	Ignition switch	~
			IPC Reference	~	~	06 pin	05	White/Yellow	~	Ignition switch	~
GMC	Canyon	04-07	Data	~	~	16 pin	02	Purple	(DATA)	OBDII connector	~
			Dome Light	~	Green	14 pin	11	Purple	(-)	Behind head light switch	~
			Door Pin	~	~	~	~	Gray/Black	(-)	Driver kick panel	~
			Passlock	~	~	06 pin	04	White/Blue or White	~	Ignition switch	~
			Accessory	~	~	06 pin	01	White/Red	(+)	Ignition switch	~
			Ignition	~	~	06 pin	03	White/Green	(+)	Ignition switch	~
			IPC Reference	~	~	06 pin	05	White/Yellow	~	Ignition switch	~
	Canyon (US model)	08	Data	~	~	16 pin	02	Purple	(DATA)	OBDII connector	~
			Dome Light	~	Green	14 pin	11	Purple	(-)	Behind head light switch	~
			Door Pin	~	~	~	~	Gray/Black	(-)	Driver kick panel	~
			Passlock	~	~	06 pin	04	White/Blue or White	~	Ignition switch	~
			Accessory	~	~	06 pin	01	White/Red	(+)	Ignition switch	~
			Ignition	~	~	06 pin	03	White/Green	(+)	Ignition switch	~
			IPC Reference	~	~	06 pin	05	White/Yellow	~	Ignition switch	~
HUMMER	H3	06-08	Data	~	~	16 pin	02	Purple	(DATA)	OBDII connector	~
			Dome Light	~	Green	14 pin	11	Purple	(-)	Behind head light switch	~
			Door Pin	~	~	~	~	Gray/Black	(-)	Driver kick panel	~
			Passlock	~	~	06 pin	04	White/Blue or White	~	Ignition switch	~
			Accessory	~	~	06 pin	01	White/Red	(+)	Ignition switch	~
			Ignition	~	~	06 pin	03	White/Green	(+)	Ignition switch	~
			IPC Reference	~	~	06 pin	05	White/Yellow	~	Ignition switch	~
			ISUZU	I-280 / I-350	05-06	Data	~	~	16 pin	02	Purple
Dome Light	~	Green				14 pin	11	Purple	(-)	Behind head light switch	~
Door Pin	~	~				~	~	Gray/Black	(-)	Driver kick panel	~
Passlock	~	~				06 pin	04	White/Blue or White	~	Ignition switch	~
Accessory	~	~				06 pin	01	White/Red	(+)	Ignition switch	~
Ignition	~	~				06 pin	03	White/Green	(+)	Ignition switch	~
IPC Reference	~	~				06 pin	05	White/Yellow	~	Ignition switch	~

TYPE 3 - WIRE CROSS REFERENCE CHART - 2 OF 2

MAKE	MODEL	YEAR	WIRE DESCRIPTION	CONNECTOR NAME	CONNECTOR COLOR	CONNECTOR TYPE	POSITION	WIRE COLOR	POLARITY	MODULE LOCATION	COMPONENT LOCATOR
ISUZU	I-290 / I-370	07-08	Data	~	~	16 pin	02	Purple	(DATA)	OBDII connector	~
			Dome Light	~	Green	14 pin	11	Purple	(-)	Behind head light switch	~
			Door Pin	~	~	~	~	Gray/Black	(-)	Driver kick panel	~
			Passlock	~	~	06 pin	04	White/Blue or White	~	Ignition switch	~
			Accessory	~	~	06 pin	01	White/Red	(+)	Ignition switch	~
			Ignition	~	~	06 pin	03	White/Green	(+)	Ignition switch	~
			IPC Reference	~	~	06 pin	05	White/Yellow	~	Ignition switch	~

TYPE 3 - WIRING DIAGRAM

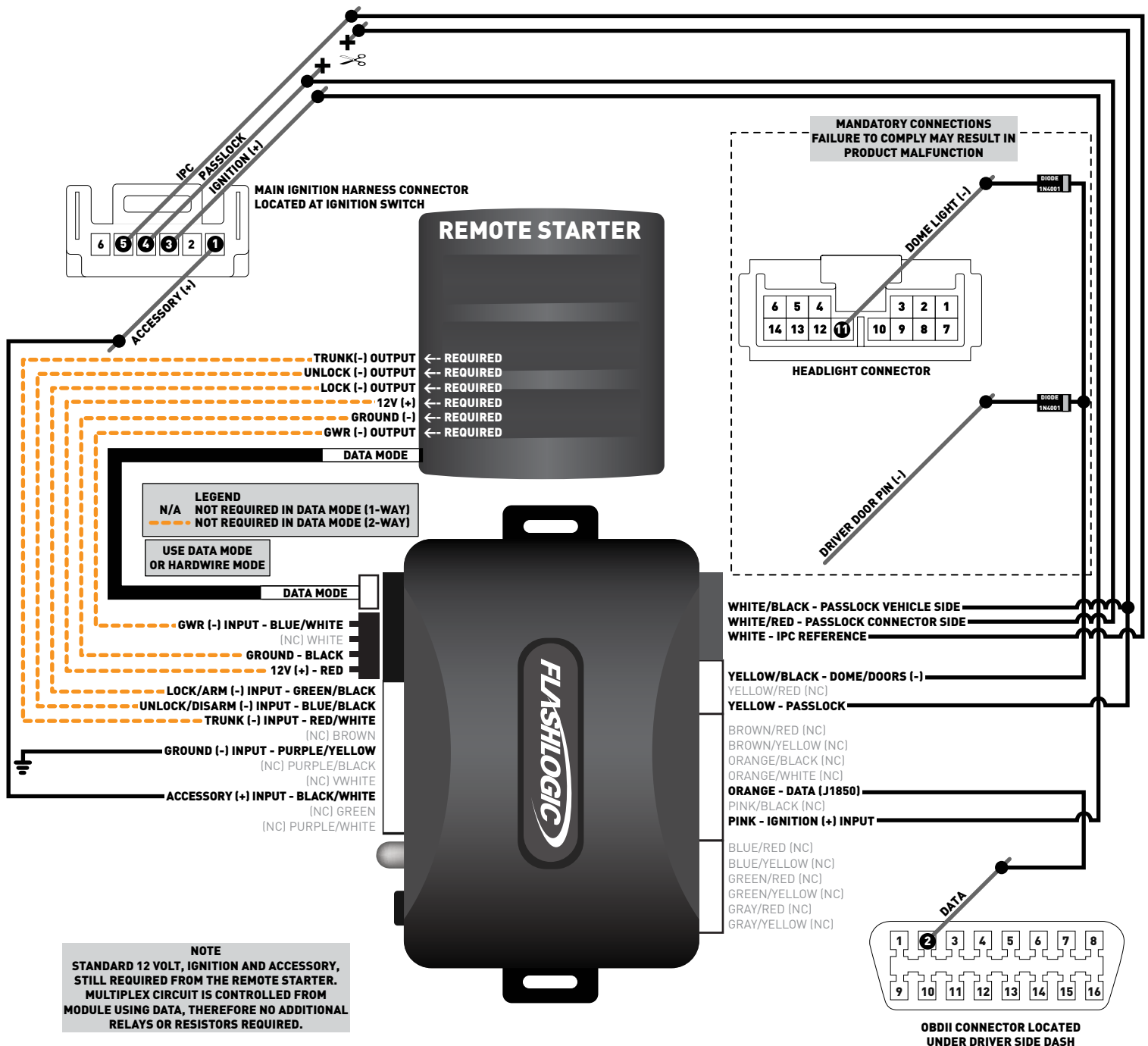

TYPE 4 - WIRE CROSS REFERENCE CHART - 1 OF 2

MAKE	MODEL	YEAR	WIRE DESCRIPTION	CONNECTOR NAME	CONNECTOR COLOR	CONNECTOR TYPE	POSITION	WIRE COLOR	POLARITY	MODULE LOCATION	COMPONENT LOCATOR
CHEVROLET	Colorado	09-12	Data	~	~	16 pin	02	Purple	(DATA)	OBDII connector	~
			Dome Light	~	Green	14 pin	11	Purple	(-)	Behind head light switch	~
			Door Pin	~	~	~	~	Gray/Black	(-)	Driver kick panel	~
			Passlock	~	~	06 pin	04	White/Blue or White	~	Ignition switch	~
			Accessory	~	~	06 pin	01	White/Red	(+)	Ignition switch	~
			Ignition	~	~	06 pin	03	White/Green	(+)	Ignition switch	~
			IPC Reference	~	~	06 pin	05	White/Yellow	~	Ignition switch	~
	Colorado (Canadian model)	08	Data	~	~	16 pin	02	Purple	(DATA)	OBDII connector	~
			Dome Light	~	Green	14 pin	11	Purple	(-)	Behind head light switch	~
			Door Pin	~	~	~	~	Gray/Black	(-)	Driver kick panel	~
			Passlock	~	~	06 pin	04	White/Blue or White	~	Ignition switch	~
			Accessory	~	~	06 pin	01	White/Red	(+)	Ignition switch	~
			Ignition	~	~	06 pin	03	White/Green	(+)	Ignition switch	~
			IPC Reference	~	~	06 pin	05	White/Yellow	~	Ignition switch	~
GMC	Canyon	09-12	Data	~	~	16 pin	02	Purple	(DATA)	OBDII connector	~
			Dome Light	~	Green	14 pin	11	Purple	(-)	Behind head light switch	~
			Door Pin	~	~	~	~	Gray/Black	(-)	Driver kick panel	~
			Passlock	~	~	06 pin	04	White/Blue or White	~	Ignition switch	~
			Accessory	~	~	06 pin	01	White/Red	(+)	Ignition switch	~
			Ignition	~	~	06 pin	03	White/Green	(+)	Ignition switch	~
			IPC Reference	~	~	06 pin	05	White/Yellow	~	Ignition switch	~
	Canyon (Canadian model)	08	Data	~	~	16 pin	02	Purple	(DATA)	OBDII connector	~
			Dome Light	~	Green	14 pin	11	Purple	(-)	Behind head light switch	~
			Door Pin	~	~	~	~	Gray/Black	(-)	Driver kick panel	~
			Passlock	~	~	06 pin	04	White/Blue or White	~	Ignition switch	~
			Accessory	~	~	06 pin	01	White/Red	(+)	Ignition switch	~
			Ignition	~	~	06 pin	03	White/Green	(+)	Ignition switch	~
			IPC Reference	~	~	06 pin	05	White/Yellow	~	Ignition switch	~
HUMMER	H3	09	Data	~	~	16 pin	02	Purple	(DATA)	OBDII connector	~
			Dome Light	~	Green	14 pin	11	Purple	(-)	Behind head light switch	~
			Door Pin	~	~	~	~	Gray/Black	(-)	Driver kick panel	~
			Passlock	~	~	06 pin	04	White/Blue or White	~	Ignition switch	~
			Accessory	~	~	06 pin	01	White/Red	(+)	Ignition switch	~
			Ignition	~	~	06 pin	03	White/Green	(+)	Ignition switch	~
			IPC Reference	~	~	06 pin	05	White/Yellow	~	Ignition switch	~
			ISUZU	I-290	09	Data	~	~	16 pin	02	Purple
Dome Light	~	Green				14 pin	11	Purple	(-)	Behind head light switch	~
Door Pin	~	~				~	~	Gray/Black	(-)	Driver kick panel	~
Passlock	~	~				06 pin	04	White/Blue or White	~	Ignition switch	~
Accessory	~	~				06 pin	01	White/Red	(+)	Ignition switch	~
Ignition	~	~				06 pin	03	White/Green	(+)	Ignition switch	~
IPC Reference	~	~				06 pin	05	White/Yellow	~	Ignition switch	~

TYPE 4 - WIRE CROSS REFERENCE CHART - 2 OF 2

MAKE	MODEL	YEAR	WIRE DESCRIPTION	CONNECTOR NAME	CONNECTOR COLOR	CONNECTOR TYPE	POSITION	WIRE COLOR	POLARITY	MODULE LOCATION	COMPONENT LOCATOR
ISUZU	I-370	09	Data	~	~	16 pin	02	Purple	(DATA)	OBDII connector	~
			Dome Light	~	Green	14 pin	11	Purple	(-)	Behind head light switch	~
			Door Pin	~	~	~	~	Gray/Black	(-)	Driver kick panel	~
			Passlock	~	~	06 pin	04	White/Blue or White	~	Ignition switch	~
			Accessory	~	~	06 pin	01	White/Red	(+)	Ignition switch	~
			Ignition	~	~	06 pin	03	White/Green	(+)	Ignition switch	~
			IPC Reference	~	~	06 pin	05	White/Yellow	~	Ignition switch	~

TYPE 4 - WIRING DIAGRAM

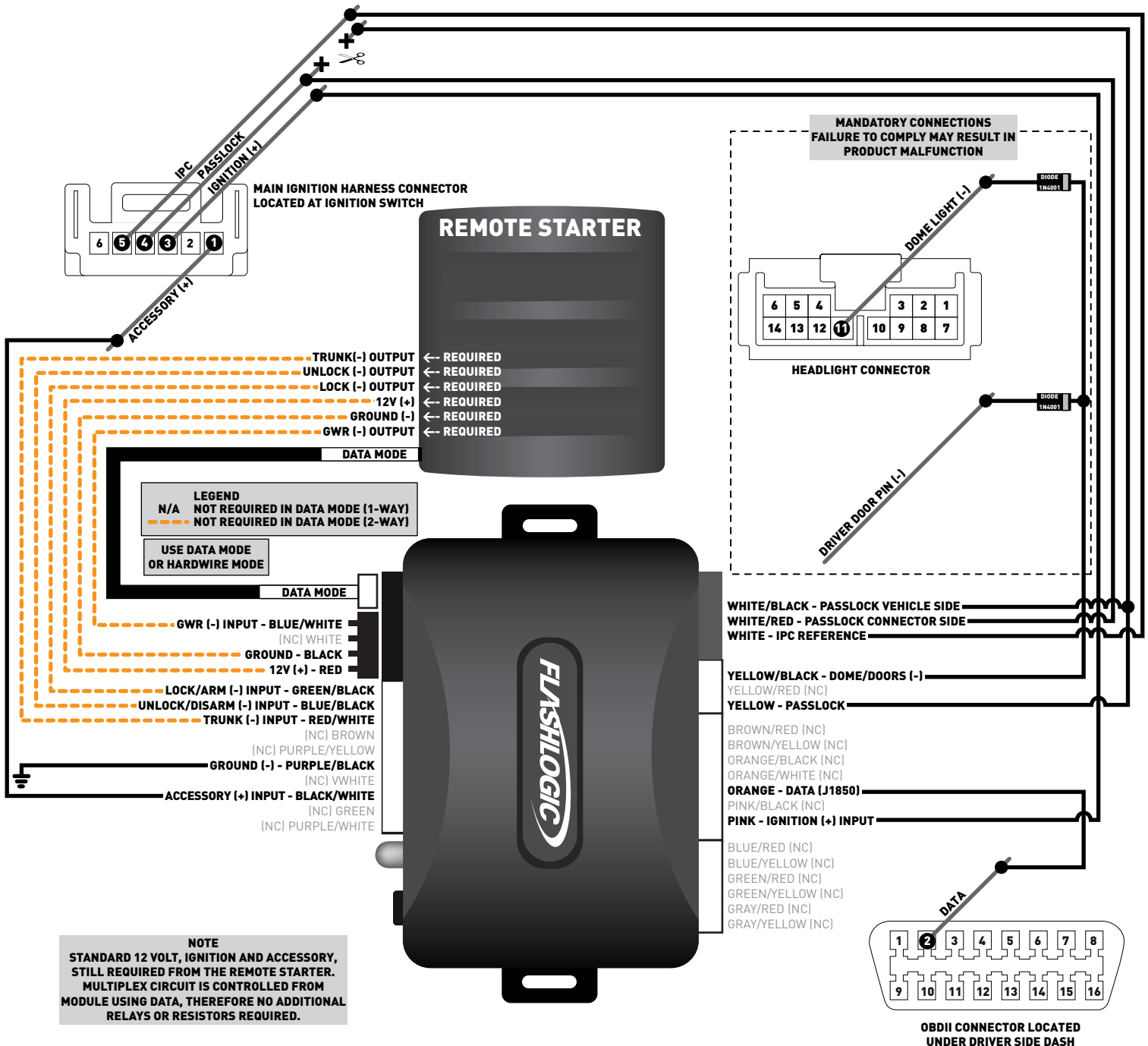

INSTALLATION MODE SELECTION

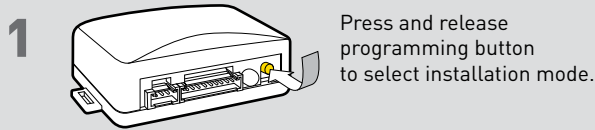

LED flashes (1X) once = DATA MODE
 LED flashes (2X) twice = STANDARD HARDWARE MODE

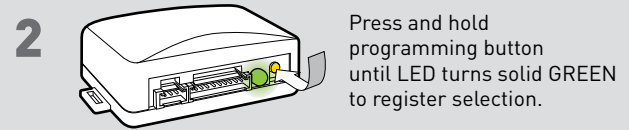

! After registration, follow Factory Reset Procedure to change installation mode and restart this procedure.

TYPE 1, 3 & 4 - MODULE PROGRAMMING PROCEDURE

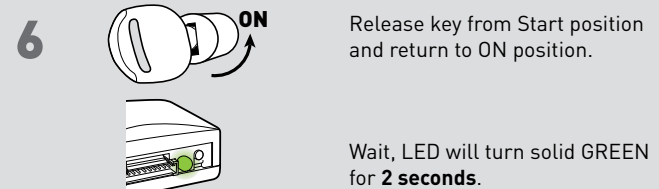
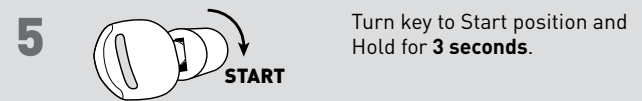
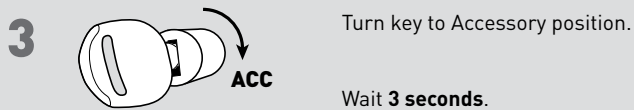
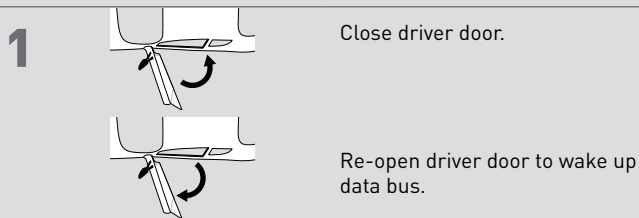

8 Module Programming Procedure completed.

TYPE 2 - MODULE PROGRAMMING PROCEDURE

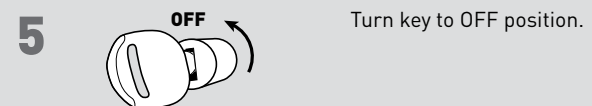
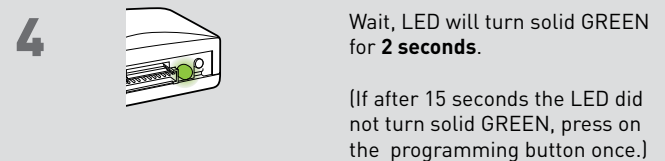
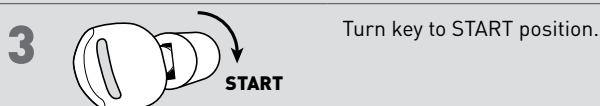
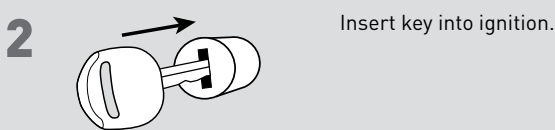
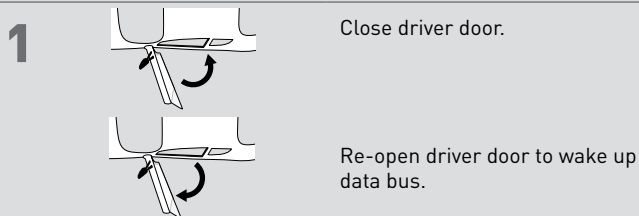

6 Module Programming Procedure completed.

IDENTIFY VEHICLE YEAR

1 Locate the Vehicle Identification Number (VIN), identify the 10th character then match it to its corresponding year.



A	1980	L	1990	Y	2000	A	2010
B	1981	M	1991	1	2001	B	2011
C	1982	N	1992	2	2002	C	2012
D	1983	P	1993	3	2003	D	2013
E	1984	R	1994	4	2004	E	2014
F	1985	S	1995	5	2005	F	2015
G	1986	T	1996	6	2006	G	2016
H	1987	V	1997	7	2007	H	2017
J	1988	W	1998	8	2008	J	2018
K	1989	X	1999	9	2009	K	2019

MODULE DIAGNOSTICS

LED STATUS	DIAGNOSTICS		
	DURING PROGRAMMING	DURING REMOTE START	WITH IGNITION OFF
Flashing RED	Missing/wrong information from firmware or vehicle	Incorrectly programmed	Incorrectly programmed or connected
Solid RED	Waiting for more vehicle information	Incorrectly programmed	Not programmed waiting for more vehicle information
Flashing GREEN	Additional steps required to complete programming	Correctly programmed and operational	False ground when running status from remote starter
Solid GREEN then OFF	Correctly programmed	Reset in progress	Reset in progress
OFF	No activity or already programmed	Invalid ground when running status from remote starter	At rest and ready for a remote start sequence

FACTORY RESET PROCEDURE

- DISCONNECT** all connectors from module **EXCEPT** the black 4-PIN standard or optional data connector.
- DISCONNECT** black 4-PIN standard or optional data connector.
- PRESS AND HOLD** programming button while connecting either 4-PIN standard or optional data connector.
- When LED flashes red, **RELEASE** programming button.

- LED will turn solid red for 2 seconds.
RESET COMPLETED.

- RECONNECT** all connectors.

- Repeat programming procedure.

! Failure to follow procedure may result with a DTC or a CHECK ENGINE error message.